



NYLON SCREW MOUNTING SUPPORT



- **Applications:**
For supporting & holding cable /wire bunch
- **Material:** Nylon 6: UL 94 V-2
- **Color:** Natural
- **Operating Temp:** -40°C to +85°C
- **Unit:** 100 Pcs/Pkt

Features:

- Its unique design provides maximum stability to the wire bundles
- Hold wire / cables bundles and help to routing of the same as desired
- Allow multiple cable to run in parallel (NS-8, 8A, 8B)

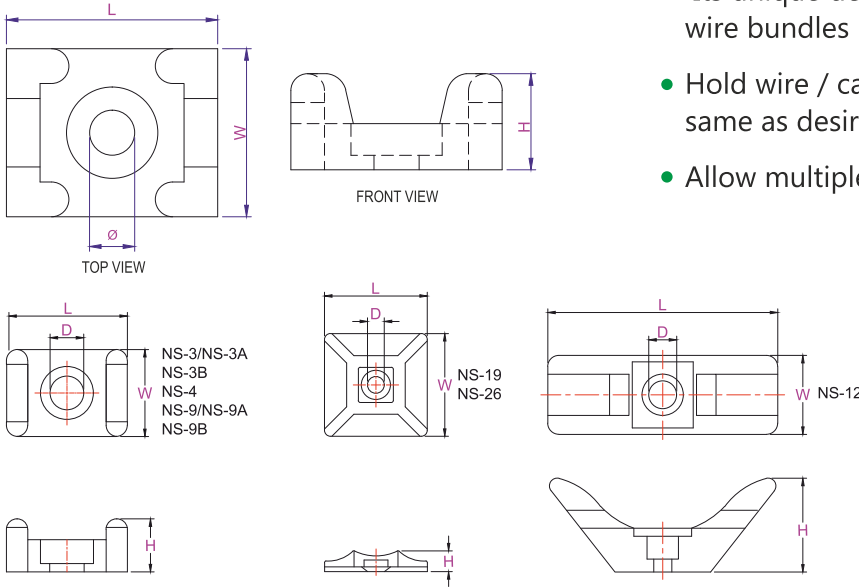

Length L (mm)	Width W (mm)	Height H (mm)	Slot Size L x W (mm)	Mounting Hole Ø Dia (mm)	For Cable Tie width (mm)	Cat. No. Natural
15.5	10.2	7	6 x 1.2	4.5	3.6	NS-3
16.5	11.5	7.2	7.5 x 1.5	4.5	4.8	NS-4
22	17.5	10	11.8 x 2.5	4.5	7.8/8.1/9.1	NS-9
41.2	18.4	16	14.2 x 3.5	5.7	12.5	NS-12
15.5	10.2	6.8	5.8 x 1.20	4.6	3.6	NS-3A
15.5	10.2	6.8	5.8 x 1.20	3.8	3.6	NS-3B
19	19	4.8	4.5 x 1.3	5	3.6	NS-19
21.9	17.35	9.5	11 x 2.30	5.1	7.8/8.1//9.1	NS-9A
21.9	17.35	9.5	11 x 2.30	6.6	7.8/8.1//9.1	NS-9B
25.5	25.5	5.2	6.2 x 1.4	4.5	4.8	NS-26

* Tolerance Dimension (mm):- Length - ± 1, Width - ±0.5, Height - ±0.5, Slot - ± 1, Mounting Hole - ± 0.6



NYLON SCREW MOUNTING SUPPORT

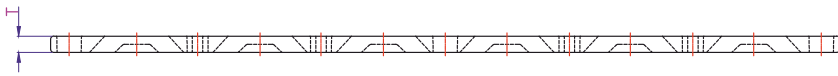
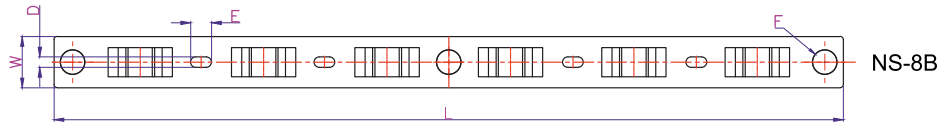
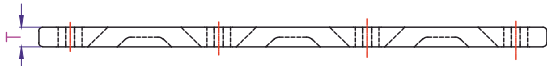
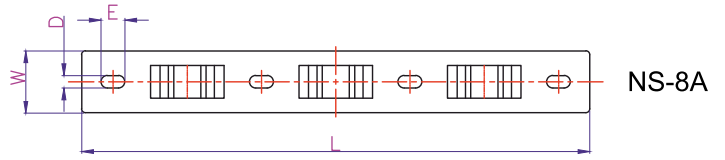
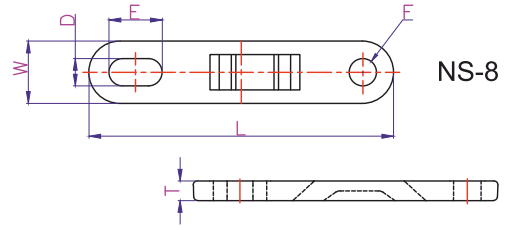

Length L (mm)	Width W (mm)	Thick T (mm)	D (mm)	E (mm)	F Dia (mm)	For Cable Tie Width (mm)	Cat. No. Natural
78	16	5	7.00	13.5	7.0	7.8/8.1	NS-8
130	15.8	5	3.80	6.1		7.8/8.1	NS-8 A
243	15.8	5	3.80	6.4	7.6	7.8/8.1	NS-8 B

* Tolerance Dimension:- Length(mm)- ± 2 Width(mm)- ± 0.3 Thickness(mm)- ± 0.2

* Other Tolerance Dimension:- ± 0.3